

CHELSEA® 210 SERIES

PTO for Ford 10R140 Super Duty Transmission

Parker Chelsea's 210 Series PTO was engineered for Ford's 10R140 Super Duty transmission, making it an ideal choice for a range of applications. The 10-bolt housing design of the 210 Series enables the use of larger pump options when compared to our 249 Series (for Ford 6R140 transmissions). Ford's 10R140 transmission features Live-Drive which allows operators to engage the PTO while the truck is in motion, increasing productivity and reducing downtime. To make ordering easy, kitting options have been streamlined so pumps, wiring harnesses, and shift kits are available in the same package as the PTO.

Applications:

- Aerial Trucks
- Tow and Recovery Trucks
- Fire and Rescue Trucks
- Water Drilling Trucks

Product Features and Benefits:

- Patented Noise Suppression System – Dampens gear rattle between transmission and PTO.
- Standard SmartStart Drive Line Output – Shock load dampening feature to protect driven equipment.
- Simplification – Same housing can be used for 2WD and 4WD installations.
- Intermittent Torque Rating – Up to 235 lb-ft for driven equipment based on 144% PTO output speed.
- Ease of Ordering – PTO, pump, wiring harness, and shift kits available under one part number and package.
- Standard SAE Output Flange and Shafts – Allowing for wider variety of flows and pressures.

U.S. Pat. No. 12,366,289

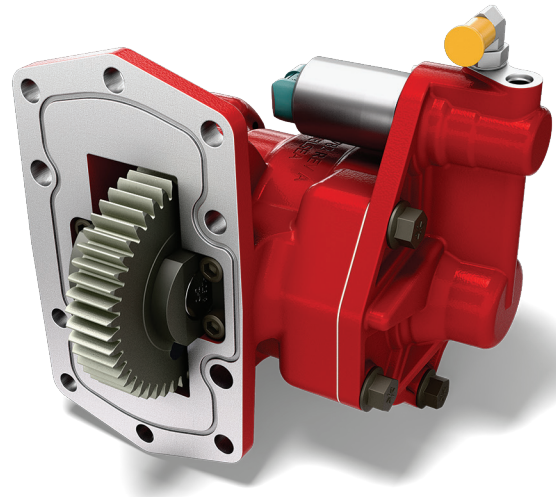

210 Series



210 Series Power Take-Off – Ford 10-Bolt 10R140

Model Number Designator

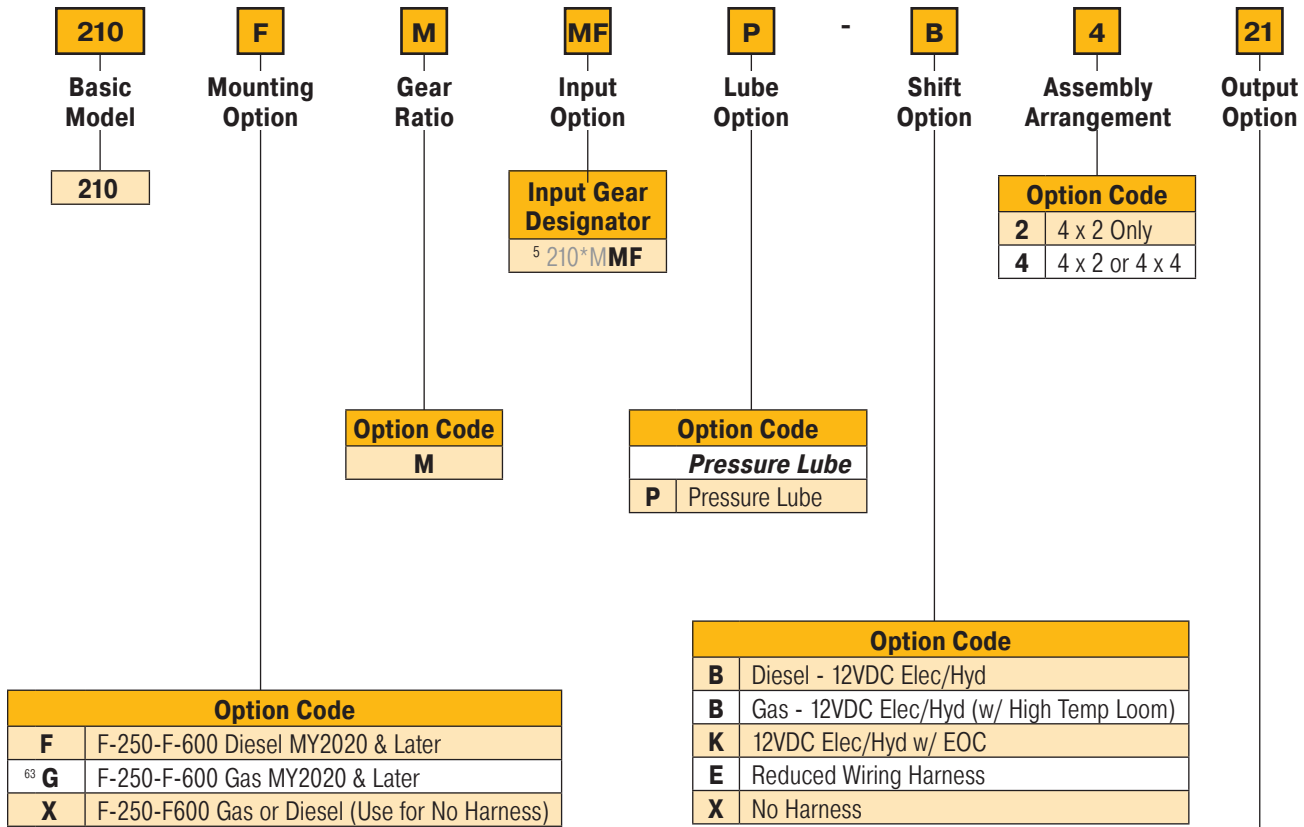

Option Code	
Driveline Output	
³⁸ SD	SmartStart - Rd Standard Shaft (1-1/4" - 5/16" Key)
Pump Mount	
8	Hyd Pump 12.5 GPM @ 1200 Eng. RPM
9	Hyd Pump 14.6 GPM @ 1200 Eng. RPM
11	Hyd Pump 16.7 GPM @ 1200 Eng. RPM
15	Hyd Pump 19.7 GPM @ 1200 Eng. RPM
³⁸ 18	Hyd Pump 23.6 GPM @ 1200 Eng. RPM
21	Hyd Pump 3.3 GPM @ 1200 Eng. RPM
26	Hyd Pump 4.1 GPM @ 1200 Eng. RPM
32	Hyd Pump 4.9 GPM @ 1200 Eng. RPM
37	Hyd Pump 5.7 GPM @ 1200 Eng. RPM
42	Hyd Pump 6.6 GPM @ 1200 Eng. RPM
50	Hyd Pump 7.8 GPM @ 1200 Eng. RPM
55	Hyd Pump 8.6 GPM @ 1200 Eng. RPM
61	Hyd Pump 9.4 GPM @ 1200 Eng. RPM
71	Hyd Pump 11.1 GPM @ 1200 Eng. RPM
82	Hyd Pump 12.7 GPM @ 1200 Eng. RPM
87	Hyd Pump 13.5 GPM @ 1200 Eng. RPM
AD	SAE A Pilot 2-Bolt Flange (3/4" - 11T)
XP	Special SAE A Pilot 2-Bolt Flange, SAE B Shaft (7/8" - 13T)

⁵ Automatically pressure lubed

³⁸ 4 x 2 Vehicles only

⁶³ Includes wiring harness with high temperature loom and heat shield

210 Series Power Take-Off – Ford 10-Bolt 10R140

Specifications – For PTO output information see application catalog

Chelsea CGP-P11 Series Pump Specs for 4 x 2 and 4 x 4 Vehicles (3/4" - 11 Tooth Pump Spline – AD Output)												
Order Code w/ PTO (C)	Chelsea Pump Model	Displacement (in ³ /rev)	GPM (A)	Pump (A) HP	Torque (A) lb-ft	Pressure PSI		Max Speed RPM		Max Pump Flow GPM	Rear Pump Ports	
						Intermittent	Continuous	Pump	Engine (B)		Inlet	Outlet
21	CGP-P11A021-5AC	0.49	3.30	7.0	24.6	3,988	3,625	4,000	1,728	4.8	SAE 12	SAE 10
26	CGP-P11A026-5AC	0.61	4.11	8.7	30.7	3,988	3,625	3,600	1,728	5.9	SAE 12	SAE 10
32	CGP-P11A032-5AC	0.73	4.91	10.4	36.7	3,988	3,625	3,500	1,728	7.1	SAE 12	SAE 10
37	CGP-P11A037-5AC	0.85	5.72	12.1	42.7	3,988	3,625	3,300	1,728	8.3	SAE 12	SAE 10
42	CGP-P11A042-5AC	0.98	6.60	14.0	49.3	3,988	3,625	3,000	1,728	9.5	SAE 12	SAE 10
50	CGP-P11A050-5AC	1.16	7.81	16.5	58.3	3,770	3,625	3,000	1,728	11.3	SAE 12	SAE 10
55	CGP-P11A055-5AP	1.28	8.62	17.1	60.5	3,480	3,410	2,800	1,728	12.5	SAE 16	SAE 12
61	CGP-P11A061-5AP	1.40	9.43	18.0	63.4	3,408	3,265	2,800	1,728	13.6	SAE 16	SAE 12
71	CGP-P11A071-5AP	1.65	11.11	17.9	63.0	2,900	2,755	2,300	1,597	14.8	SAE 16	SAE 12
82	CGP-P11A082-5AP	1.89	12.72	17.8	62.8	2,465	2,395	2,300	1,597	16.9	SAE 16	SAE 12
87	CGP-P11A087-5AP	2.01	13.53	17.8	62.7	2,320	2,250	2,000	1,389	15.7	SAE 16	SAE 12

Chelsea PGP-315 Series Pump Specs for 4 x 2 and 4 x 4 Vehicles (3/4" - 11 Tooth Pump Spline – AD Output)												
Order Code w/ PTO	Chelsea Pump Model	Displacement (in ³ /rev)	GPM (A)	Pump (A) HP	Torque (A) lb-ft	Pressure PSI		Max Speed RPM		Max Pump Flow GPM	Rear Pump Ports	
						Intermittent	Continuous	Pump	Engine (B)		Inlet	Outlet
8	CGP-P31B081-5AG	1.86	12.52	24.1	85.1	3,300	3,300	3,000	1,728	18.1	SAE 16	SAE 16
9	CGP-P31B094-5AG	2.17	14.61	24.7	87.2	2,900	2,900	3,000	1,728	21.1	SAE 16	SAE 16
11	CGP-P31B107-5AG	2.48	16.70	24.4	86.0	2,500	2,500	3,000	1,728	24.2	SAE 16	SAE 16

(A) GPM & Pump Input HP @ 1200 Engine RPM (1728 PTO Output RPM - 144% Ratio) & Continuous Pressure Rating with 90% efficiency rating considered.
 (B) Max Engine Speed = Minimum of (1) (Max Pump Speed)/1.44 PTO Ratio and (2) 2500 RPM maximum PTO output speed. PTO output speeds above 2500 RPM requires application approval from Parker Chelsea.
NOTE: Minimum ideal engine speed for Ford Super Duty in stationary mode is 900 RPM (Diesel) and 700 RPM (Gas). Consult fordbbas.com
NOTE: Ford's 10R140 transmission delivers up to 300 lb-ft to PTO. Consult fordbbas.com for power and torque limitations based on vehicle configuration.

FORMULAS:
 GPM = Cu. In. x .004329 = G/Rev x 1728 RPMs x .90 efficiency
 HP = (GPM x Max PSI)/1714
 Torque = (HP x 5252)/1728 RPMs

210 Series Power Take-Off – Ford 10-Bolt 10R140

Dimensions – For PTO output information see application catalog

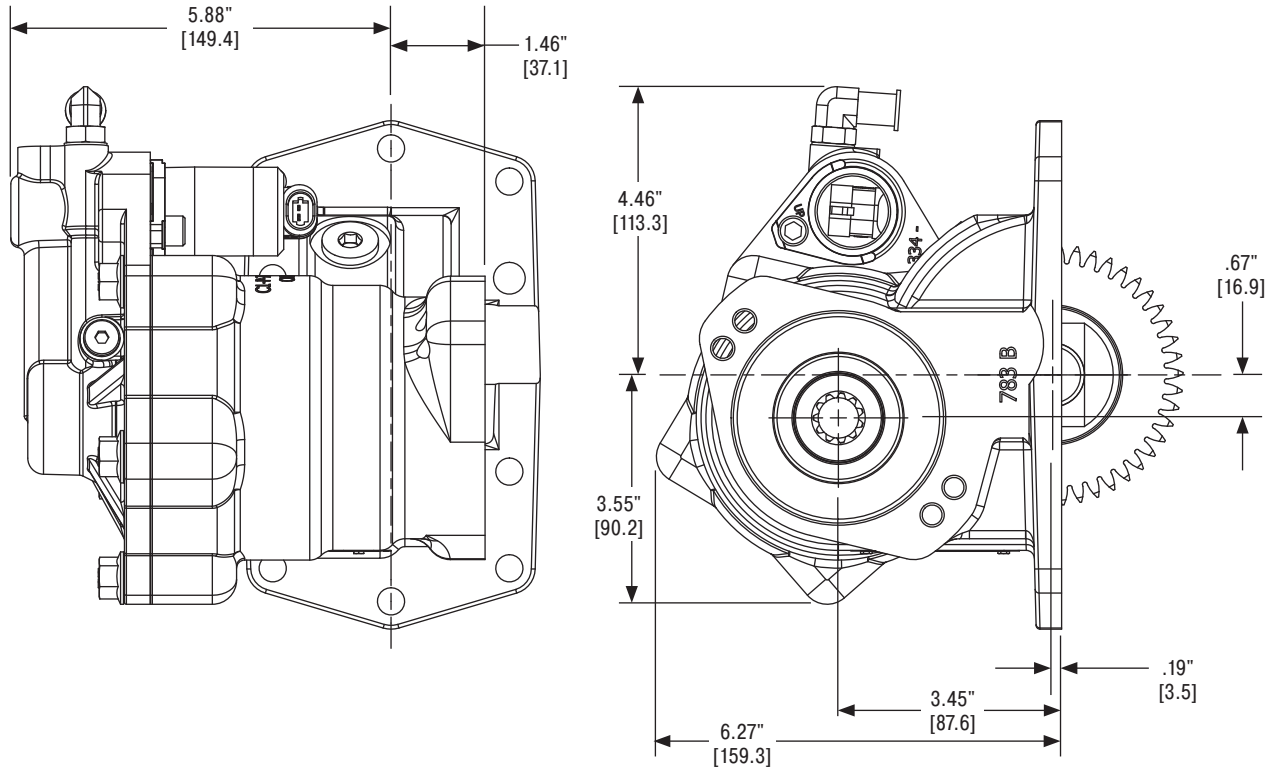

Parker Hannifin Corporation
Chelsea Products Division
8225 Hacks Cross Road
Olive Branch, MS 38654 USA
phone 1-888-PH4-TRUK (1-888-744-8785)
chd_support@support.parker.com
www.parker.com/chelsea

HY25-0198-B1/US November 2025

© 2025 Parker Hannifin Corporation

